

Sketch diagram of executive Block

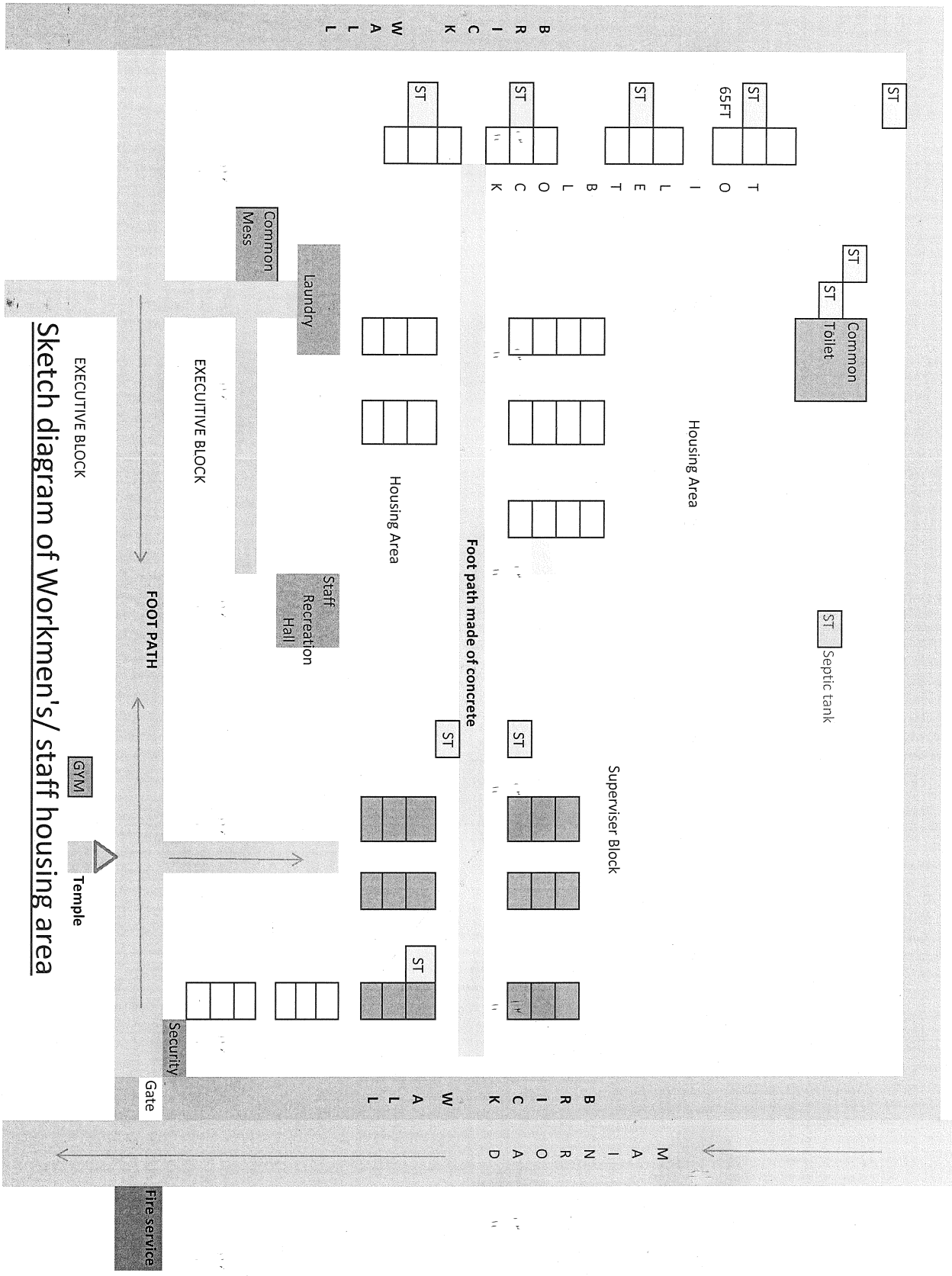

Sketch diagram of Workmen's/ staff housing area

**Annexure -3**

There are 39 nos of septic tanks in different locations of Kharsang Oil Field as shown in the following table. The size of the septic tanks is not equal. Out of these 11 no of septic tanks is made of Hume Pipe .The Size of Septic tank of Hume pipe is ( length 7.5 ft and diameter 2 Ft ). The average size of rest septic tanks are made of brick and their average size are ( 3.3 Mtr x 1.5 Mtr x 1.5 Mt)

<b>Sl.no</b>	<b>Location</b>	<b>Qty.( Numbers)</b>	<b>No of User</b>	<b>Frequency of Cleaning</b>
1	Executive Mess Area	13	30-35 persons	1 -2 tanks / month
2	Supervisor & Staff Housing Area	11	50-60 persons	2- 3 tank/ month
3	Security & Driver Block	01	55- 60 persons	On need Basis
4	Admin Office	01		On need Basis
5	Civil & Geologist	01		On need basis
6	Medical	01		On need basis
7	Fire Station	01		On need basis
8	CRPF Camp	04	70- 80 persons	On need basis
9	Store	01		On need basis
10	U&M	01		On need basis
11	OCS	01		On need basis
12	Boiler & Power House	01		On need basis
13	Security Office & Old Medical	02		On need basis
		<b>39</b>		